

JOINSCAN LEDs

T.80B 0.8 INCH (20.32mm) TRIAD DIGIT 59.2 X 27.5 X 8.2mm

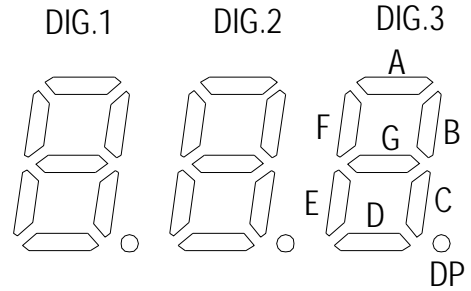

UNIT : mm
TOLERANCE : ±0.2mm
◀ = GREEN
▶ = RED

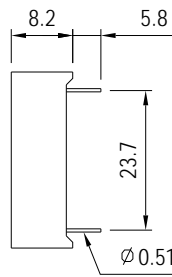
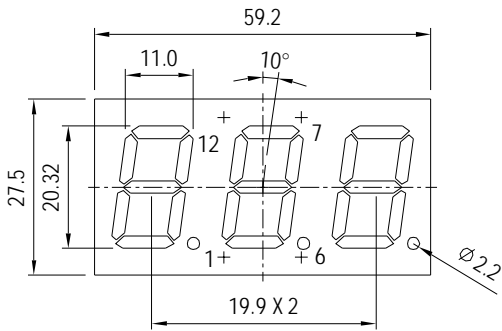
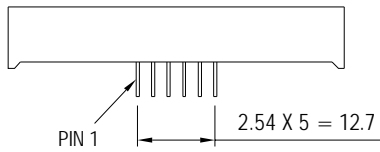

A. E8038 SERIES

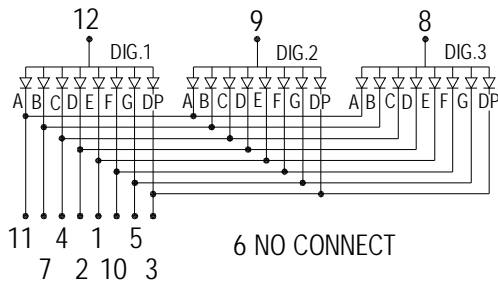

C. E8037C

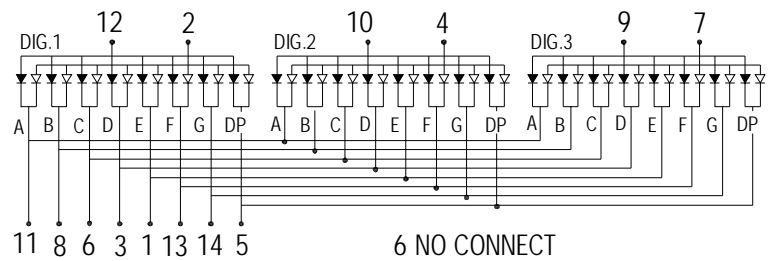

B. F8038 SERIES

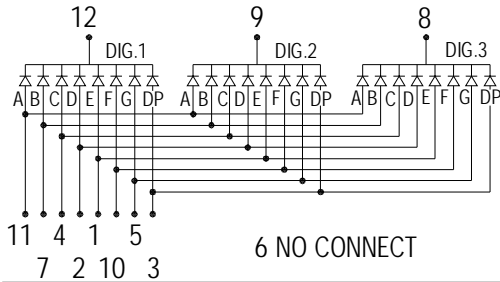

D. F8037C

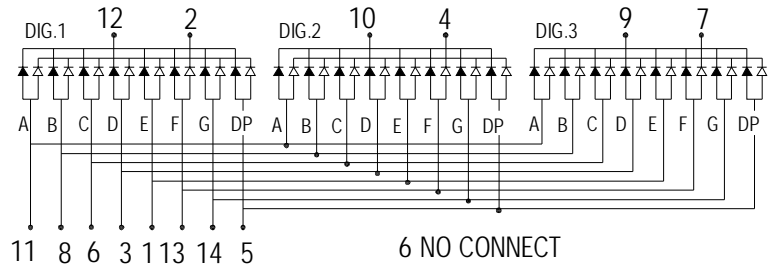

PIN FUNCTION	COLOR	COMMON ANODE			COMMON CATHODE			WAVE LENGTH (nm)	IR MAX (uA) VR=5V	VF (V) IF=20mA	LUMINOUS INTENSITY IF=20mA
		A model no.	C model no.	E model no.	B model no.	D model no.	F model no.				
GaP	RED	E8038H			F8038H			695	100	2.2	0.6mcd
GaAsP	ORANGE RED	E8038O			F8038O			635	100	2.0	4.0mcd
GaP	GREEN	E8038G			F8038G	F8037C		570	100	2.2	4.5mcd
Gap	Yellow	E8038Y			F8038Y			600	100	2.2	4.0mcd
GaAIAs	SUPER RED	E8038RS			F8038RS			650	100	1.8	8.0mcd
GaAIAs	ULTRA RED										
GaAIAs	YELLOW GREEN										
Sic	BLUE	E8038SF			F8038SF			465±5	100	3.6	15.0mcd
ZnSe	WHITE										

Model No. - BW BLACK SURFACE WHITE SEGMENT
- BR BLACK SURFACE RED SEGMENT
- GW GRAY SURFACE WHITE SEGMENT

Remark :

1. Typical forward current 10 - 20mA, MAXimum forward current 25mA
2. Solder Temperature 1.6mm Below Seating plane less 5 seconds at 260°C +5°C -30°C
3. Peak Foward current Per Dice, Duty cycle 1 / 10, 10KHZ, MAXimum 120mA
4. Operating Temperature From -25°C to 85°C
5. RoHS COMPLIANT